



South Battery Park City Resiliency Project Construction Logistics

Community Board 1 Battery Park City Committee July 18, 2022



NEW YORK
STATE OF
OPPORTUNITY.

**Battery Park
City Authority**

Coastal Modeling

- **Not Based on Outdated Models:** The flood protection models used to develop SBPCR are not outdated. They are built to existing FEMA standards, which are considered best available data.
- **Compliant with LL96 of 2013:** Law requires that the NYC Building Code, and therefore the coastal flood protection projects built in compliance with it, use the more restrictive of either FEMA's 2007 Effective Flood maps or any Preliminary Flood maps released since then.
- **Consistent with Citywide Approach:** BPCA's resiliency projects, like every other resiliency project in New York City, are designed to meet the legal standards.
- **Insurance Implications:** One of the results of the City's challenge of the 2015 Preliminary Flood Insurance Rate Map was to delay the increase in flood insurance costs for New York City homeowners, not to lower the long-term planning criteria for flood mitigation projects. LL96 codified this distinction: it protected homeowners from insurance cost escalations while also ensuring that new construction is built to last.
- **NPCC Standard:** The standards BPCA is meeting are also informed by the NYC Panel on Climate Change (NPCC). NPCC comprises carefully selected experts in disciplines related climate change and its impacts. NPCC's 2015 SLR projections, which were reaffirmed in 2019, considered the best available data and modeling approaches for all sources and is geared toward achieving the best possible adaptation outcome for NYC.

The Site

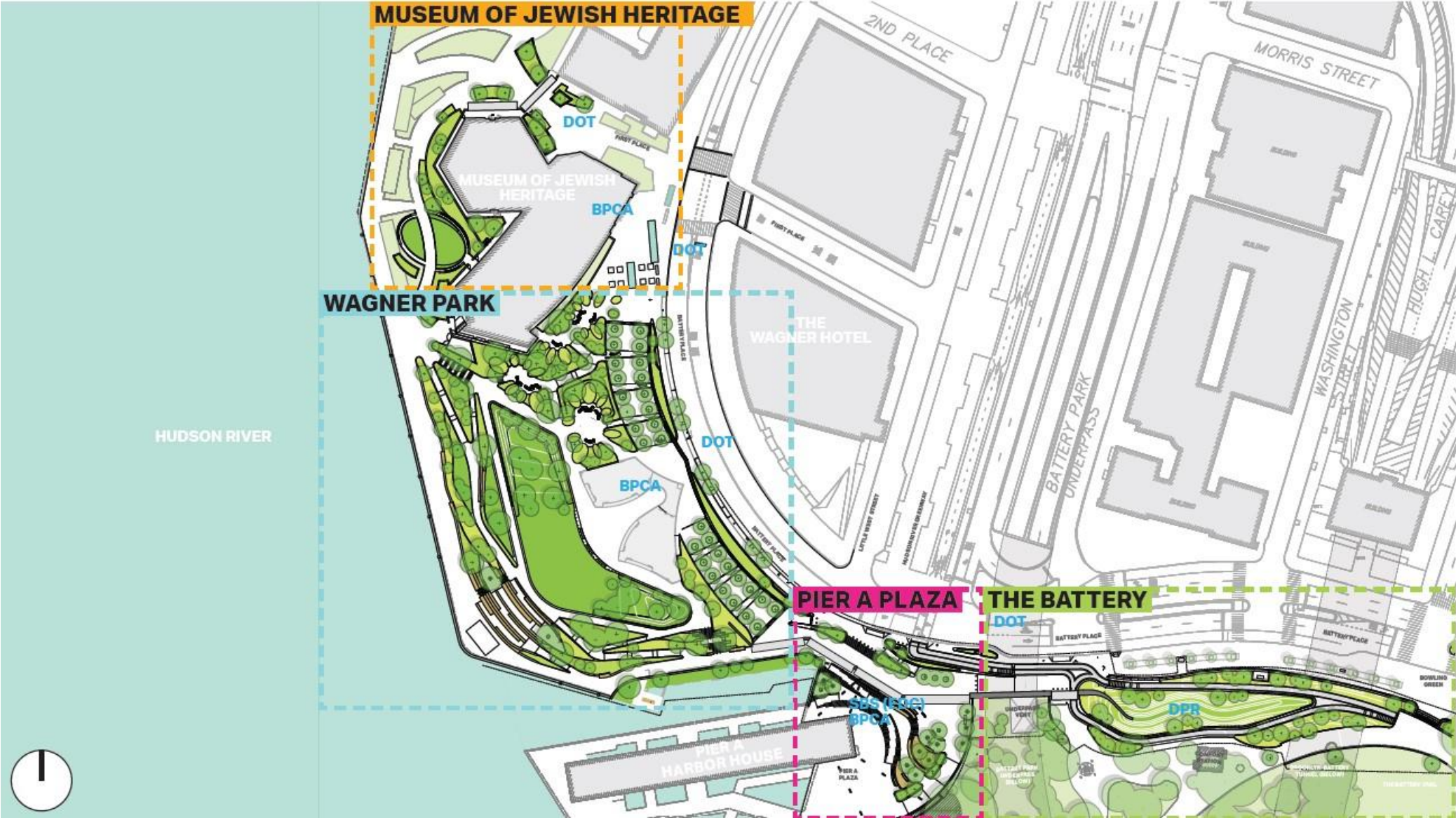

Pedestrian Circulation During Construction

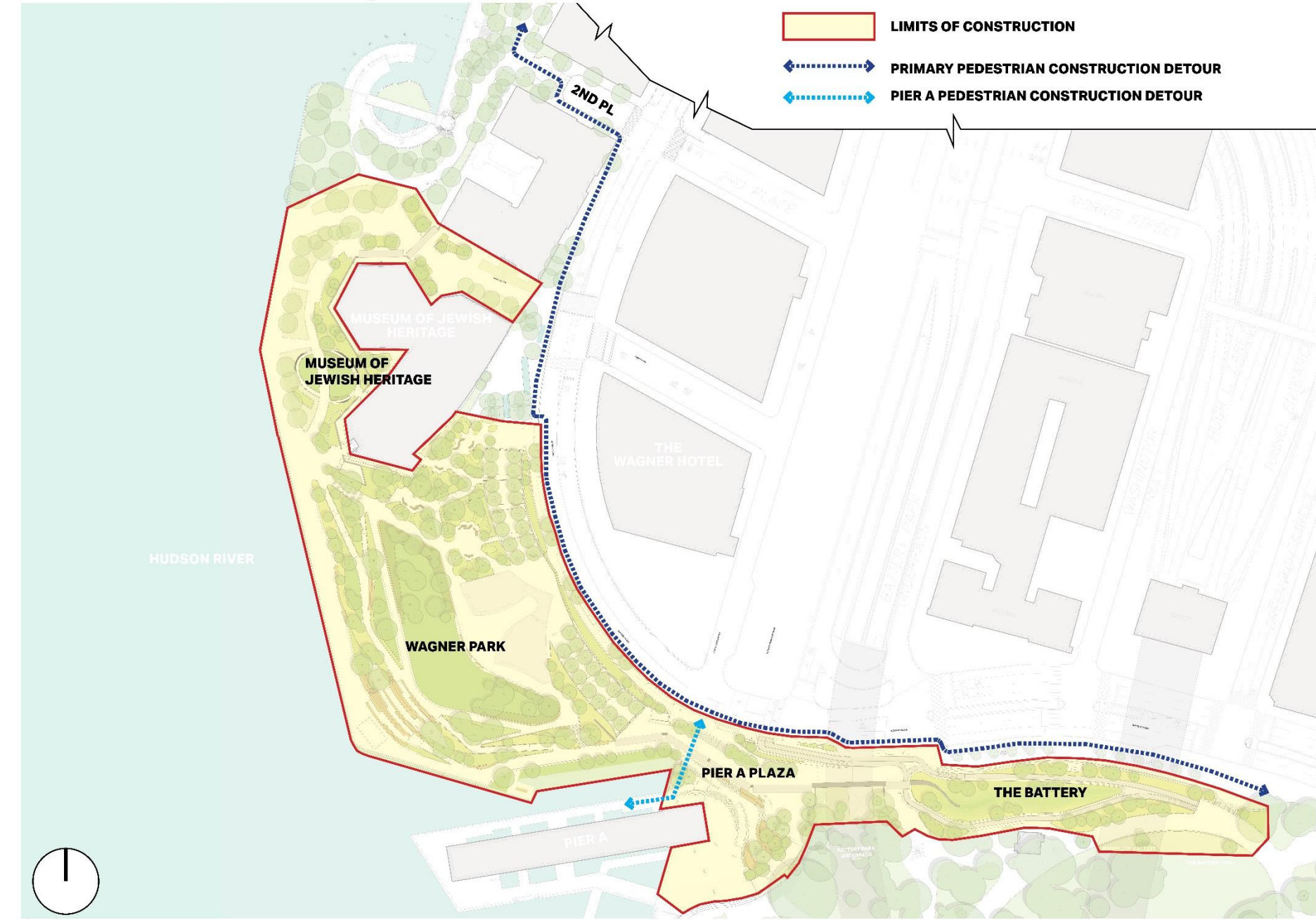

Traffic Circulation During Construction



Bike Circulation During Construction



Construction Logistics – Wagner Park and MJH (Early Fall)

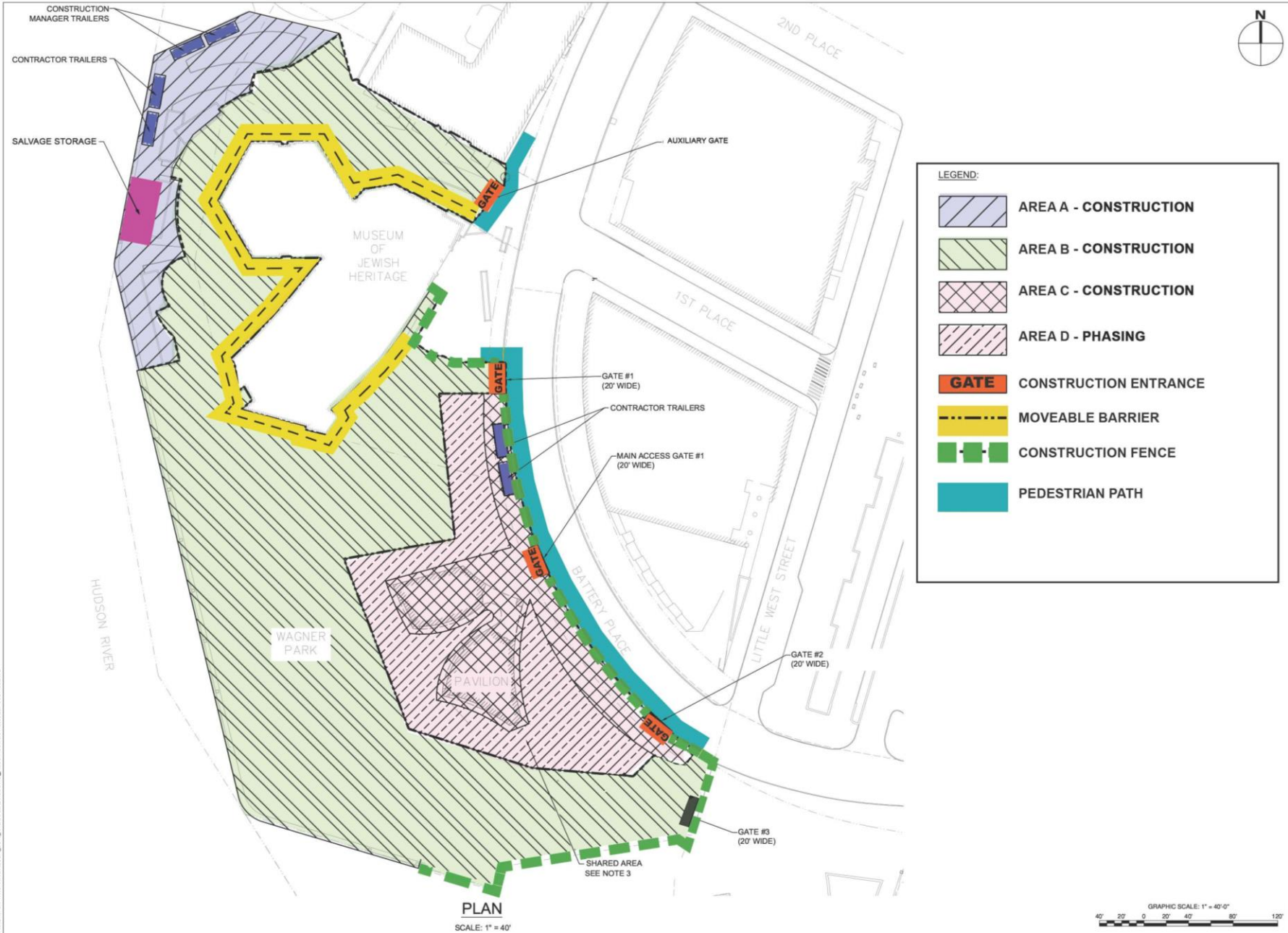

Construction Logistics – Pier A Plaza and the Battery (Late Fall)



Site Signage During Construction

Site Signage:

- DOB Required Signage
 - Placed at key site access points
 - Project Informational Panel
 - Permits & Safety Signage
- Project Specific Informational Signage
 - Placed along Battery Place fence frontage
 - Placed along northern site boundary
 - Content yet to be defined, but will target a resiliency and informational theme



Materials Storage and Staging

- Materials storage will not happen on site; materials will be delivered on a “just in time” basis.
- Staging and storage in the northwest corner of the site will be limited to contractor and construction manager trailers and storage of salvaged materials designated for reuse on the site.
 - Activity related to movement of this material will be very limited.
- 1st Place entrance will not be the primary construction entrance to the site and will be limited to access related to work performed in the immediate area.
- Special attention and MPT precautions to apply for ensure safety for 1st Place crosswalks and school access.
- Starting time for noisy construction work in this area will be pushed back to 8:00 rather than 7:00.



**Battery Park
City Authority**

South Battery Park City Resiliency Project

General Construction Information

Anticipated Project Duration to Substantial Completion:

- MJH, Wagner Park and Wagner Park Pavilion: 24 months
- Pier A and the Battery: 20 months
- Interior Drainage: 12 months

Typical Days/Hours of Work:

- Monday - Friday 7:00-3:30pm
- Saturday 8:00- 4:00pm
- Shifts may be adjusted from time to time
- Work activities such as road resurfacing and utility work may be done off hours to minimize traffic/stakeholder impact
- Flaggers will present for construction vehicles entering and exiting the work zone

Construction Community Liaison:

- Rick Fogarty of Melissa Johnson Associates
- Email questions to: sbpcrinfo@bpca.ny.gov

Questions?

Thank You