



South Battery Park City Resiliency Project Update

Community Board 1 Environmental Protection Committee

September 20, 2022



NEW YORK
STATE OF
OPPORTUNITY.

**Battery Park
City Authority**

WAGNER PARK LAWN REVISIONS

WAGNER PARK PREVIOUS DESIGN

WAGNER LAWN TODAY: 33,750 SF
PREVIOUS DESIGN: 17,250 SF

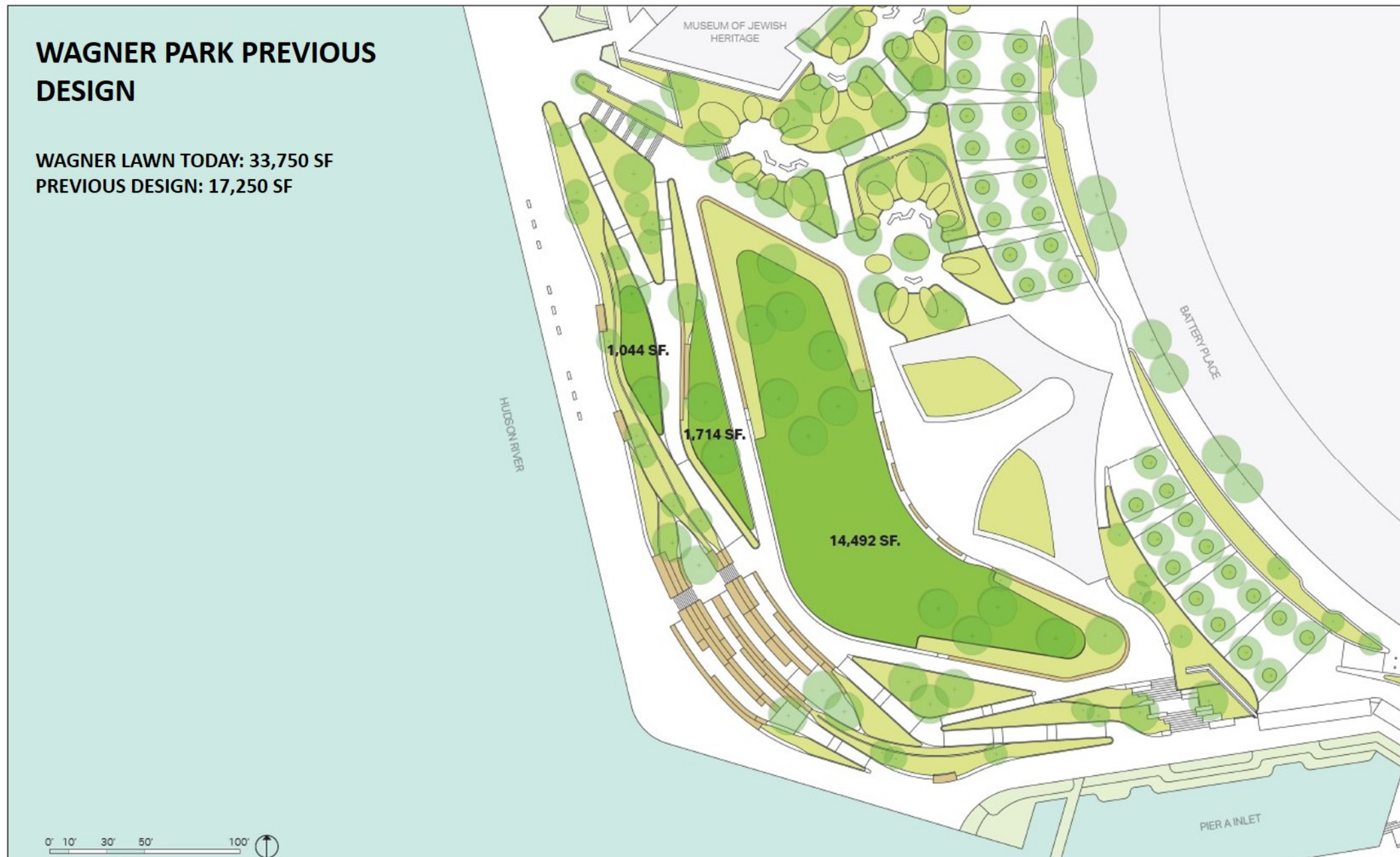

Wagner Park Lawn – Previous Design

DESIGN REVISION

WAGNER LAWN TODAY:	33,750 SF
PREVIOUS DESIGN:	17,250 SF
MAXIMIZED LAW:	30,050 SF
REMOVED HARDSCAPE	6,922 SF

APPROXIMATE NEW TREES ADDED: 10

DESIGN CRITERIA

- Increase lawn size to approximately 30,050 SF
- Increase total number of trees in Wagner Park.
- Reduce amount of hardscape.

DESIGN OBJECTIVES

- Simplify access to lawn with gentle topography.
- Strengthen relationship between lawn and northern gardens.
- Increase diversity of lawn experiences through tree planting, gentle topography, and integrated garden beds.



Wagner Park Lawn – Design Revision

1st Place Design Revisions



1st Place Design – Preliminary PDC Submission



1st Place Design Revision – Final PDC Submission

WATERFRONT EDGE DESIGN GUIDELINES (WEDG) CERTIFICATION

WEDG Rating System

SBPC Resiliency - Wagner Park

Achievability				Points tentatively achieved in Preliminary Review (107.5)		Points possible for achievement in Final Review (35)	
hi	med	low	np	115 points are needed for certification			
107.5	34.0	30.5	41.0				
26	1	1	0	0. Site Assessment & Planning		Standard	Responsible
6				Credit 0.1	Develop a Multi-Disciplinary Design Team	Provide narrative and contracts list showing a multi-disciplinary team of professionals experienced in waterfront development, and includes a biologist/ environmental professional, coastal/ geotechnical engineer, and a landscape architect or architect. Also illustrate collaboration employed including pre-design site visits and meetings.	AECOM
10				Credit 0.2	Assess Site-Wide Social & Ecological Context & Vulnerabilities	Provide a site assessment which includes analysis of the project site that informed the design approach in line with site conditions, and a baseline from which to measure performance over time.	AECOM / MKA
6				Credit 0.3	Develop & Implement an Equitable Plan for Community Engagement	Engage community stakeholders including the public and exceeding what is required by government agencies in planning and community participation over the life of the project (4 points); and regularly engaging public over time (+1 point); and a human health & wellbeing impacts assessment indicating adjustments to the design (+1 point).	AECOM / BPCA
4	1	1		Credit 0.4	Create a Maintenance & Adaptive Management Plan	Plan for the maintenance, ongoing performance (that is monitored over time), and adaptive management of waterfront projects by establishing funding and ensuring it occurs for the project.	SiteWorks / BPCA
22	2	4	10	1. Responsible Siting & Coastal Risk Reduction		Standard	Responsible
8		2		Credit 1.1	Avoid or Reduce Risk from Coastal Hazards	Provide narrative, or annotated site plans and construction documents that demonstrate the site is designed for coastal risks. Redundant strategies and secondary protective measures that minimize losses to business operations, or adverse environmental impacts, are incorporated into the design. Additional points are possible if the project demonstrates measurable risk reduction to adjacent communities (+3 points).	AECOM
8				Credit 1.2	Site with Ecological Sensitivity	Site structures away from, or include a buffer, between critical habitats and areas of high human activity. Provide site plans that indicate that permanent structures are not over water, wetlands, or other ecologically sensitive areas.	LAUD / Nautilus
6				Credit 1.3	Site or Design Structures to Improve Visual & Other Sensory Connections to the Water	Provide site plans that enhance and maximize light, air and visual and psychological access to the water from upland areas. Specifically demonstrate incorporation of a variety of views (sight lines continuing the street grid to the waterfront) through landscaping, elevation, seating, or other referenced strategies.	AECOM / LAUD
			10	Credit 1.4	Support Industrial Water-Dependent Uses	Provide narrative that describes policies, measures, or requirements that show support and preserve water-dependent uses related to maritime industry and commercial shipping.	N/A
	2	2		Credit 1.5	Establish an Emergency Preparedness & Response Plan	Develop a plan and provide information to protect human safety by planning for emergencies, which includes effective communications and operations both prior and following extreme events.	AECOM / BPCA
23	1	9	19	2. Community Access & Connections		Standard	Responsible
12				Credit 2.1	Provide Quality Public Access Areas on the Waterfront	Provide a site plan that demonstrates that at least 90% of the site area is for parks that create or improve high quality public access areas and promote a equitable, engaging and healthy waterfront.	LAUD / AECOM
			4	Credit 2.2	Reduce Industrial Impacts to Human Health & Wellbeing	Provide a narrative, annotated site plans, or construction documents that demonstrate that the adverse impacts of on-site industrial operations (including wayfinding barriers, dust, odor, and noise) have been minimized to the surrounding community.	N/A
5	1			Credit 2.3	Provide Diverse Programming & Passive Educational Features	Provide a narrative, annotated site plans, or construction documents that describe/ demonstrate how the design provides robust programming opportunities to enhance the visitor experience for the historical, cultural, and environmental context.	Nautilus / AECOM / BPCA
1			4	Credit 2.4	Increase Transportation Access to the Waterfront	Provide narrative and/or documentation demonstrating how public access to the site has been improved by expanding and encouraging sustainable transportation (esp. waterborne) options. Projects sited within (0.5 mile) walking distance of public transit (+1 point); Providing funds for a water or land-based transportation service, or agreement to extend public transit (+2 points).	A10
		2	6	Credit 2.5	Create Maritime-Related Employment Opportunities	Provide narrative and documentation of job, partnership, employment opportunities and training in maritime fields to support local economy & water-related industries.	BPCA
5				Credit 2.6	Increase Waterfront Pathway & Greenway Connectivity	Provide annotated site plans and/or narrative identifying features that increase ADA compliant connectivity along the waterfront to promote physical activity, health & well-being and encourage non-motorized transport.	SiteWorks / LAUD
		5		Credit 2.7	Provide Direct Connections to the Water for People & Boats	Enable people to safely and directly access and interact with the water to enhance human well-being and promote stewardship of the waterways.	AECOM / A10
		2	5	Credit 2.8	Support Diverse & Sustainable Maritime Activity	Provide annotated construction documents and narratives that demonstrate strategies that promote low-impact, safe design that accommodates a diverse range of vessels and facilitates educational planning. Historic or cultural uses incl. mooring for historic vessels (+2 points).	AECOM / BPCA / Nautilus

WEDG Preliminary Scorecard (115 points required for certification)
(Preliminary BPCA Score: 107.5, Possible Additional Points: 27)



**Battery Park
City Authority**

9	0	0	9	3. Edge Resilience	Standard	Responsible
6			2	Credit 3.1 Choose An Appropriate Edge Strategy for the Context & Intended Use	Provide a narrative detailing stabilization that ensures the structural integrity and sustainability of the shoreline and near shore area. Points are awarded based on percentage of shoreline length restored or maintained.	AECOM
1			1	Credit 3.2 Maintain or Emulate Natural Shoreline Shape	Provide documentation that shows design supporting native biodiversity and reducing impact by maintaining or mimicking local, natural shoreline to the extent possible.	AECOM / LAUD
			6	Credit 3.3 Protect the Working Edge	Provide construction documents and narrative indicate use of fenders or other sufficient protection for general use and storm conditions to protect the edge from structural damage over time due to active use.	AECOM / A10
2				Credit 3.4 Ecologically Enhance Structural Components	Lower the impact and improve the biodiversity of man-made edges through mimicking the structural heterogeneity and materials of the natural, local shoreline. Hardened edges (if required) should incorporate enhancements or designs that are supportive of biodiversity and abundance beyond conventional methods (eg. incorporating live plants and shellfish into rip-rap, textured surfaces, etc.) along at least 25% of the shorelines, and no less than 50 feet.	Nautilus / AECOM
27.5	22	8.5	3	4. Natural Resources	Standard	Responsible
10			2	Credit 4.1 Maintain & Restore Biodiversity & Ecosystem Services	Provide narrative and plans that demonstrate how significant habitats are being preserved, maintained intact, or impacts minimized to natural resources and the ecosystem services they provide. Points are based on avoiding a loss to ecosystem services, and plans to recover lost services, any disturbances must be minimal, and mitigating negative impacts (+6 points). Restoring and/or preserving habitat based on size (+2/+4 points).	AECOM / Nautilus
	6			Credit 4.2 Preserve and Increase Ecosystem Connectivity	Provide site plan and narrative that show the increase in the diversity of habitats, restore continuity of ecosystems, and reduce fragmentation. Points are based on average patch size as % of total new landscaped area, providing contiguous habitat, or new connectivity between at least two habitat types. <i>Note: must achieve credit 4.1 to earn points for this credit.</i>	AECOM / Nautilus
	6			Credit 4.3 Support Native Habitat Complexity & Biodiversity	Provide planting plans, maintenance & adaptive management plan that shows supportive native, rare, and biodiverse ecosystems through careful planting selection and management. Points are based on total % of total planned coverage of native plants (those not listed on state invasive species lists): 75% or more of total planned coverage (+4 points), and 85% or more (+6 points).	SiteWorks / LAUD
4				Credit 4.4 Avoid Human Disturbance to Natural Resources	Provide site plan and narrative that demonstrates water buffers and sensitive (IESNA and Intl Dark Sky Assoc guidelines) site lighting measures taken to reduce ongoing disturbance to wildlife due to human activity.	AECOM / SiteWorks
		4		Credit 4.5 Redvelop & Clean Up Contaminated Sites	Provide letter or memo demonstrating agency approval of completed cleanup, or reduced contamination in the environment on site.	AECOM
	2			Credit 4.6 Sustainable Fill & Soil Management	Provide narrative and documentation indicating reductions in the environmental impacts associated with fill use and management. Points are available if materials are re-used (authorized for re-use, ie. not exceeding state-regulated contamination levels) on site at least 30% of total usable (1 point); OR at least 50% of total fill used is from local sources within 30 miles if moved by truck, or up to 50 miles if moved by barge.	AECOM / LIRo
		2		Credit 4.7 Resilient Energy Sources	Provide site plan, narrative and calculations on anticipated on-site renewable energy production. Meet 50% / 100% (1 or 2 points) of annual site-wide outdoor energy needs respectively.	A10 / W. Allen
	2			Credit 4.8 Practice Environmentally-Responsible Construction	Provide a narrative that details the measures taken to reduce the environmental impact of construction on site such as minimizing soil compaction, avoiding impacts to any identified critical habitat, and also the diversion of waste generated from landfills.	AECOM / LIRo
10				Credit 4.9 Reduce & Manage Stormwater Quantity	Provide narrative and calculations that show the anticipated reduction in the overall volume of stormwater volume, using recharge or infiltration whenever feasible. Points are allocated based upon meeting a 50-yr, 24 hr rainfall event, or 95th percentile precipitation event and the discharge rate not exceeded (+6 points); or a 100-yr, 24hr rainfall event, or more than the 95th percentile precipitation event, and the discharge rate relative to the pre-project condition is not exceeded (+8 points).	MKA
	2	2		Credit 4.10 Improve Stormwater Discharge Quality	Provide narrative and calculations that show the anticipated improvement in the overall volume of stormwater quality, using recharge or infiltration whenever feasible. Points are available for application of fertilizer and chemical pest control that avoids the wettest times of year (+1 point); OR no pesticides, fertilizers, or herbicides used on site (+2 points). If the project captures additional volume to accommodate projected regional increases in precipitation due to climate change, or accommodates stormwater volume from sites beyond the project boundary (+2 points).	MKA
2			1	Credit 4.11 Reduce Water Use	Provide narrative and calculations that show the anticipated reduction in impact on freshwater resources as well as load to municipal systems and potential for combined sewer overflows (CSO's). Up to 3 points are available for greywater reuse, reduction in outdoor water use, treating wastewater, and reducing indoor water use.	A10 / SiteWorks
1.5		0.5		Credit 4.12 Reduce Contribution to Urban Heat	Provide narrative and annotated site plan with calculations showing reductions of impervious surfaces, and use of high-albedo materials that help to reduce contributions to the cumulative impacts of impervious and heat-absorbing surfaces. Credit is based on % of the unbuilt (without buildings) portion of the site that is composed of greenscapes or plantings: @ 50% = 0.5 point, greater than 50% = 1 point). High albedo materials on 75% (0.5 points), or ALL (1 point) applicable materials, including roofs, pavement and awnings.	LAUD / TPP
	4			Credit 4.13 Partner with Academic & Scientific Institutes to Study or Monitor the Site	Provide narrative, copy of agreement with academic, scientific, or research institution describing the scope of the partnership specific to tracking, monitoring and evaluation, and a plan for publishing data collected. Permission to Waterfront Alliance to make at least a subset of assessment and monitoring data (over time) available to researchers (+1 point). Additionally any monitoring needs to be for at least 5 years (+1 point).	BPCA / Nautilus
0	8	8	0	5. Innovation & Exemplary Performance	Standard	Responsible
	4	4		Credit 5.1 Inventive Design	A project can submit a maximum of two new proposed WEDG credits (4 points each, for a total up to 8 points maximum) that encourages innovative design and pilot studies of new materials and methods	A10
	4	4		Credit 5.2 Exemplary Performance	A project can score credit for significantly surpassing the current requirements of WEDG, up to a maximum of two proposed credits (4 points each, for a total up to 8 points max).	A10

WEDG Preliminary Scorecard (115 points required for certification)

(Preliminary BPCA Score 107.5, Possible Additional Points 27)